

## LEVELING DEVICES- Low Cost High Value Series With Pad

Low Cost High Value Levelers are available in both stud styles and socket styles, with or without elastomer pad.

### Steel and Stainless Steel

Vlier HI-VALUE Stud Style Steel/Stainless Steel Leveling Devices provide an integrally machined stud as part of the ball. Stud Style Bases swivel 15° off the centerline to adjust to uneven surfaces and level machine tools, electronic racks, benches, etc. Zinc plate with gold chromate finish is standard, add '3' to end of part number for new Nickel Finish.

Stainless Steel Leveling Devices offer the advantage of an all-stainless steel design for maximum protection against rust and corrosion.

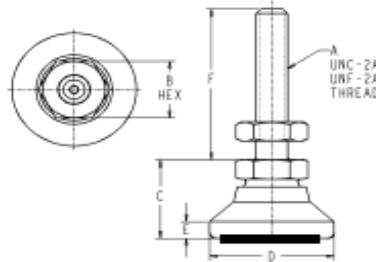

Part No.	Max load (lbs)	A Thread	B Hex	C* Height to Hex	D Pad Diameter	E	F Bolt Length
<b>HVEP298S</b>	525	10-32	3/8	17/32	3/4	7/64	1
<b>HVEP299S</b>	525	10-32	3/8	17/32	3/4	7/64	2
<b>HVEP300S</b>	800	1/4-20	1/2	45/64	1	5/32	1-1/4
<b>HVEP301S</b>	800	1/4-20	1/2	45/64	1	5/32	2.5
<b>HVEP304S</b>	2,800	3/8-16	5/8	7/8	1-1/4	3/16	2
<b>HVEP305S</b>	2,800	3/8-16	5/8	7/8	1-1/4	3/16	4
<b>HVEP306S</b>	3,750	1/2-13	3/4	1-1/8	1-7/8	1/4	2
<b>HVEP307S</b>	3,750	1/2-13	3/4	1-1/8	1-7/8	1/4	4
<b>HVEP308S</b>	4,500	5/8-11	7/8	1-1/4	2-1/2	5/16	2
<b>HVEP309S</b>	4,500	5/8-11	7/8	1-1/4	2-1/2	5/16	4
<b>HVEP310S</b>	5,400	3/4-10	1-1/16	1-1/2	3	1/2	2
<b>HVEP311S</b>	5,400	3/4-10	1-1/16	1-1/2	3	1/2	4
<b>HVEP312S</b>	16,400	1-8	1-3/8	1-7/8	4	13/32	4-1/4
<b>HVEP313S</b>	16,400	1-8	1-3/8	1-7/8	4	13/32	8

	Max load (lbs)	A	B	C*	D	E	F
Steel Nickel Finish		Thread	Hex	Height to Hex	Pad Diameter		Bolt Length
<b>HVEP298S3</b>	525	10-32	3/8	17/32	3/4	7/64	1
<b>HVEP299S3</b>	525	10-32	3/8	17/32	3/4	7/64	2
<b>HVEP300S3</b>	800	1/4-20	1/2	45/64	1	5/32	1-1/4
<b>HVEP301S3</b>	800	1/4-20	1/2	45/64	1	5/32	2.5
<b>HVEP304S3</b>	2,800	3/8-16	5/8	7/8	1-1/4	3/16	2
<b>HVEP305S3</b>	2,800	3/8-16	5/8	7/8	1-1/4	3/16	4
<b>HVEP306S3</b>	3,750	1/2-13	3/4	1-1/8	1-7/8	1/4	2
<b>HVEP307S3</b>	3,750	1/2-13	3/4	1-1/8	1-7/8	1/4	4
<b>HVEP308S3</b>	4,500	5/8-11	7/8	1-1/4	2-1/2	5/16	2
<b>HVEP309S3</b>	4,500	5/8-11	7/8	1-1/4	2-1/2	5/16	4
<b>HVEP310S3</b>	5,400	3/4-10	1-1/16	1-1/2	3	1/2	2
<b>HVEP311S3</b>	5,400	3/4-10	1-1/16	1-1/2	3	1/2	4
<b>HVEP312S3</b>	16,400	1-8	1-3/8	1-7/8	4	13/32	4-1/4
<b>HVEP313S3</b>	16,400	1-8	1-3/8	1-7/8	4	13/32	8

	Max load (lbs)	A	B	C*	D	E	F
Stainless Steel/ Passivated		Thread	Hex	Height to Hex	Pad Diameter		Bolt Length
<b>HVESSP298S</b>	525	10-32	3/8	17/32	3/4	7/64	1
<b>HVESSP299S</b>	525	10-32	3/8	17/32	3/4	7/64	2
<b>HVESSP300S</b>	800	1/4-20	1/2	45/64	1	5/32	1-1/4
<b>HVESSP301S</b>	800	1/4-20	1/2	45/64	1	5/32	2.5
<b>HVESSP304S</b>	2,800	3/8-16	5/8	7/8	1-1/4	3/16	2
<b>HVESSP305S</b>	2,800	3/8-16	5/8	7/8	1-1/4	3/16	4
<b>HVESSP306S</b>	3,750	1/2-13	3/4	1-1/8	1-7/8	1/4	2
<b>HVESSP307S</b>	3,750	1/2-13	3/4	1-1/8	1-7/8	1/4	4
<b>HVESSP308S</b>	4,500	5/8-11	7/8	1-1/4	2-1/2	5/16	2
<b>HVESSP309S</b>	4,500	5/8-11	7/8	1-1/4	2-1/2	5/16	4
<b>HVESSP310S</b>	5,400	3/4-10	1-1/16	1-1/2	3	1/2	2
<b>HVESSP311S</b>	5,400	3/4-10	1-1/16	1-1/2	3	1/2	4
<b>HVESSP312S</b>	16,400	1-8	1-3/8	1-7/8	4	13/32	4-1/4
<b>HVESSP313S</b>	16,400	1-8	1-3/8	1-7/8	4	13/32	8

## Metric LEVELING DEVICES- Low Cost High Value Series No Pad

Low Cost High Value Levelers are available in both stud styles and socket styles, with or without elastomer pad.

### Steel and Stainless Steel

Vlier HI-VALUE Stud Style Steel/Stainless Steel Leveling Devices provide an integrally machined stud as part of the ball. Stud Style Bases swivel 15° off the centerline to adjust to uneven surfaces and level machine tools, electronic racks, benches, etc. Zinc plate with gold chromate finish is standard, add '3' to end of part number for new Nickel Finish.

Stainless Steel Leveling Devices offer the advantage of an all-stainless steel design for maximum protection against rust and corrosion.

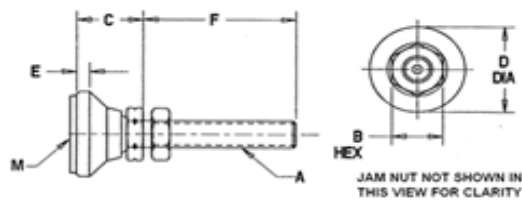

Part No.	Max load KG (lbs)	A Thread	B Hex mm	C Height to Hex +/- .02)	D Dia.	E in.	F	M Dia.
<b>HVEPM6S</b>	240 (525)	M6 x 1-6g .87 MIN FULL THD	10	0.53	0.75	0.11	1	0.63
<b>HVEPM8S</b>	375 (825)	M8 x 1.25-6g 1.08 MIN FULL THD	13	0.7	1	0.15	1.25	0.91
<b>HVEPM10S</b>	1273 (2800)	M10 x 1.5-6g 1.78 MIN FULL THD	17	0.88	1.25	0.17	2	1.12
<b>HVEPM12S</b>	1750 (3750)	M12 x 1.75-6g 1.73 MIN FULL THD	19	1.13	1.88	0.25	2	1.74
<b>HVEPM16S</b>	2046 (4500)	M16 x 2-6g 1.68 MIN FULL THD	24	1.25	2.5	0.31	2	2.37
<b>HVEPM20S</b>	2455 (5400)	M20 x 2.5-6g 1.65 MIN FULL THD	30	1.5	3	0.5	2	2.87
<b>HVEPM24S</b>	7500 (16500)	M24 x 3-6g 3.75 MIN FULL THD	36	1.88	4	0.4	4.25	3.87

	Max load KG (lbs)	A Thread	B Hex mm	C Height to Hex +/- .02)	D Dia.	E in.	F	M Dia.
Stainless Steel								
<b>HVESSPM6S</b>	240 (525)	M6 x 1-6g .87 MIN FULL THD	10	0.53	0.75	0.11	1	0.63
<b>HVESSPM8S</b>	375 (825)	M8 x 1.25-6g 1.08 MIN FULL THD	13	0.7	1	0.15	1.25	0.91
<b>HVESSPM10S</b>	1273 (2800)	M10 x 1.5-6g 1.78 MIN FULL THD	17	0.88	1.25	0.17	2	1.12
<b>HVESSPM12S</b>	1750 (3750)	M12 x 1.75-6g 1.73 MIN FULL THD	19	1.13	1.88	0.25	2	1.74
<b>HVESSPM16S</b>	2046 (4500)	M16 x 2-6g 1.68 MIN FULL THD	24	1.25	2.5	0.31	2	2.37
<b>HVESSPM20S</b>	2455 (5400)	M20 x 2.5-6g 1.65 MIN FULL THD	30	1.5	3	0.5	2	2.87
<b>HVESSPM24S</b>	7500 (16500)	M24 x 3-6g 3.75 MIN FULL THD	36	1.88	4	0.4	4.25	3.87